

FOR LEASE

**9,395 Sq. Ft.
Industrial Space**



**23141 Arroyo Vista, Ste. 100
Rancho Santa Margarita**

Features Include:

- 3,649 Sq. Ft. Existing Office Space
- Reception, 5 Private Offices, Lg. Conference Room
- Open Office Area, Break Room
- 22' Warehouse Clearance
- 200 Amps – 120/208 volt – 3 Phase
- One 12'x14' Ground Level Loading Door
- 2.4:1 Parking Ratio (23 Stalls)
- Fire Sprinklers – Shop Restroom
- Easy Access to 241 Expressway
- Building Signage Possible



1241 N. Lakeview Avenue, Ste. F
Anaheim, CA 92807

For Further Information, Please Contact:
BRIAN DALTON or JIM POTTER
(714)777-1468 Fax (714)777-5779
www.prpropertiesinc.com

23141 Arroyo Vista, Ste. 100
9,395 Square Feet

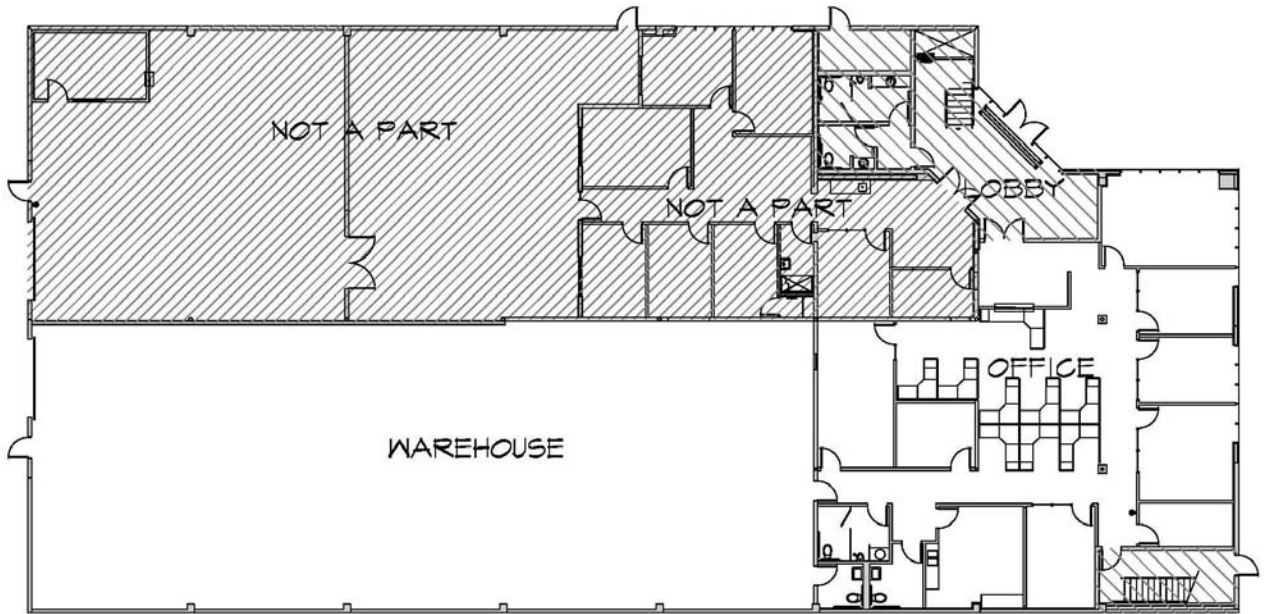

LEASE AREA

OFFICE	3649 s.f.
WAREHOUSE	5746 s.f.
TOTAL	9395 s.f.

23141 ARROYO VISTA,
RANCHO SANTA MARGARITA, CA

SUITE 100



1241 N. Lakeview Avenue, Ste. F
Anaheim, CA 92807

For Further Information Please Contact:
BRIAN DALTON or **JIM POTTER**
(714)777-1468 Fax (714)777-5779